

# Why Pay More? High Performance Energy Saving Rotary Screw Air Compressors

- **VSD Technology**
- **Permanent Magnet (PM) Motors**

## SKY Air Compressors Range

- ▶ Pressure range  
13 - 1000 bar
- ▶ Volume flow  
1.2 - 100 m<sup>3</sup>/min
- ▶ Motor power  
7.5 to 560 kW



Aftermarket & Service  
Network all over Pakistan

# SK-APM Series: Direct Drive Permanent Magnet (PM) Motor & Variable Technology

## Benefits & Features

- Super IE4 class, 97% high-efficiency energy-saving PM motor.
- Latest technology screw air end, more compact and stable.
- Intelligent frequency conversion technology, energy saving up to 42%.
- Internet remote control, monitor your compressor anytime anywhere.



## Technical Parameters

VSD Models	Air Delivery (m <sup>3</sup> /min)			Power (kW)	Noise dB(A)	Outlet diameter	Dimension (mm)	Weight (Kg)
	8Bar	10Bar	13Bar				L * W * H	
SK7.5APM	0.5-1.2	0.4-1.0	0.3-0.7	7.5	63	G3/4	900*650*860	190
SK11APM	0.6-1.7	0.5-1.6	0.4-1.0	11	65	G3/4	1150*750*960	320
SK15APM	1.0-2.4	0.8-2.1	0.7-1.6	15	65	G3/4	1150*750*960	340
SK22APM	1.5-3.7	1.3-3.2	1.1-2.8	22	68	G1	1350*850*1120	430
SK30APM	2.0-5.0	1.6-3.9	1.4-3.4	30	68	G1	1500*1000*1350	600
SK37APM	2.5-6.2	2.2-5.6	2.0-4.9	37	69	G1 1/2	1500*1000*1350	650
SK45APM	3.0-7.3	2.4-6.0	2.3-5.9	45	70	G1 1/2	1500*1000*1350	730
SK55APM	3.8-9.5	3.5-8.7	3.0-7.3	55	70	G2	1700*1200*1550	950
SK75APM	5.1-12.8	4.5-11.3	3.7-9.2	75	72	G2	1700*1200*1550	1050
SK90APM	6.2-15.5	5.4-13.6	5.0-12.5	90	72	G2	2100*1400*1650	1420
SK110APM	7.8-19.6	7.1-17.8	6.2-15.5	110	72	DN65	2500*1650*1900	2200
SK132APM	9.3-23.2	7.8-19.5	7.1-17.8	132	72	DN65	2500*1650*1900	2400
Sk160APM	11.1-27.8	9.2-23.0	8.0-20.0	160	72	DN80	3000*1900*1950	3650
SK185APM	12.5-31.2	11.0-27.5	10.3-25.8	185	72	DN80	3000*1900*1950	3950
SK200APM	13.6-34.0	12.2-30.5	11.2-28.0	200	76	DN80	3600*2200*2200	4200
SK220APM	14.0-35.0	12.8-32.0	12.0-30.0	220	76	DN100	3600*2200*2200	4600
SK250APM	16.6-41.5	15.2-38.0	14.0-34.9	250	76	DN100	3600*2200*2200	5900
SK280APM	20.2-50.6	18.4-46.0	16.6-41.5	280	82	DN100	3600*2200*2200	6000
SK315APM	22.2-55.9	20.0-50.1	16.8-42.0	315	82	DN125	4600*2300*2430	7800
SK315WPM	22.2-55.9	20.0-50.1	16.8-42.0	315	82	DN125	4200*2300*2430	7500
SK355APM	26.0-65.4	22.0-55.1	18.4-46.0	355	85	DN125	4600*2300*2430	8200
SK355WPM	26.0-65.4	22.0-55.1	18.4-46.0	355	82	DN125	4200*2300*2430	7900

\*A for Air Cooled, \*W for Water Cooled

# SK-APMII Series: Two-Stage Permanent Magnet (PM) Motor & Variable Technology

## Benefits & Features

- Getting more compressed at the same power consumption.
- Two-stage compression air end, increase the efficiency 8% pm average.
- Super IE4 class, SF1.2-1.35 service factor, 97% high-efficiency energy-saving PM motor, ensure trouble-free in all weather conditions.
- Excellent oil air separation performance, outlet oil content is less than 2 ppm.
- Silent centrifugal fan, stronger wind pressure reduce the probability of heat exchanger failure.



## Lower Power Consumption, Higher Air Capacity.

## Technical Parameters

Model	Air Delivery (m <sup>3</sup> /min)				Power (kW)	Noise dB(A)	Outlet diameter	Dimension (mm)	Weight (Kg)
	7bar	8Bar	10bar	13bar				L * W * H	
SK22APMII	1.4-4.5	1.3-4.2	1.1-3.5	0.8-2.7	22	68	G11/2	1350*850*1110	600
SK30APMII	1.8-6.0	1.7-5.9	1.4-4.7	1.2-4.0	30	68	G11/2	1200*1000*1350	700
SK37APMII	2.3-7.5	2.1-6.9	1.8-6.0	1.6-5.4	37	68	G11/2	1500*1000*1350	750
SK45APMII	3.2-10.5	3.0-9.9	2.3-7.8	2.0-6.8	45	72	G2	2100*1300*1650	1250
SK55APMII	4.1-13.6	3.8-12.5	3.0-10.1	2.3-7.5	55	76	G2	2100*1300*1650	1300
SK75APMII	4.8-16.0	4.7-15.5	3.8-12.8	3.1-10.2	75	76	G2	2100*1300*1650	1350
SK90APMII	6.2-20.7	5.9-19.5	4.8-16.2	4.2-14.0	90	76	DN80	2500*1650*1900	2700
SK110APMII	7.4-24.8	7.2-24.0	6.1-20.2	4.8-16.0	110	76	DN80	2500*1650*1900	2800
SK132APMII	8.7-29.0	8.4-28.0	7.1-23.7	5.7-19.0	132	78	DN80	2500*1650*1900	3000
SK160APMII	10.2-34.0	9.8-32.5	8.4-28.0	6.9-23.0	160	78	DN80	3000*1900*1950	4300
SK185APMII	11.7-39.0	10.8-36.0	9.6-32.0	8.3-27.5	185	78	DN80	3000*1900*1950	4400
SK200APMII	13.1-43.5	12.3-41.0	10.7-35.5	9.5-31.5	200	78	DN100	3600*2200*2200	5000
SK220APMII	15.5-51.5	14.5-48.3	11.6-38.5	10.7-35.5	220	82	DN100	3600*2200*2200	5500
SK250APMII	16.2-54.0	15.3-51.0	13.5-45.0	11.4-38.0	250	82	DN100	3600*2200*2200	6000
SK280APMII	18.0-60.0	17.1-57.0	15.0-50.0	12.9-43.0	280	82	DN125	3600*2200*2200	6800
SK315APMII	19.5-65.0	18.6-62.0	16.8-56.0	15.2-50.5	315	82	DN125	4200*2300*2350	8000
SK355APMII	22.5-75.0	21.9-73.0	19.2-64.0	16.5-55.0	355	82	DN150	4200*2200*2350	8500
SK400APMII	25.2-84.0	24.6-82.0	21.6-72.0	18.3-61.0	400	82	DN150	4200*2200*2350	9800

\*A for Air Cooled, \*W for Water Cooled

# Purification System and Accessories

- Fridge Air Dryers
- Desiccant Air Dryers
- Water Separators
- Line Filters for Dust and Oil Particle Removal
- Air Receivers
- On-Site Nitrogen Gas Generators
- On-Site Oxygen Gas Generators
- Compressed Air & Gas Monitoring System
- Monitoring Solutions, including flow meters, dew point sensors, power meters and energy monitoring systems

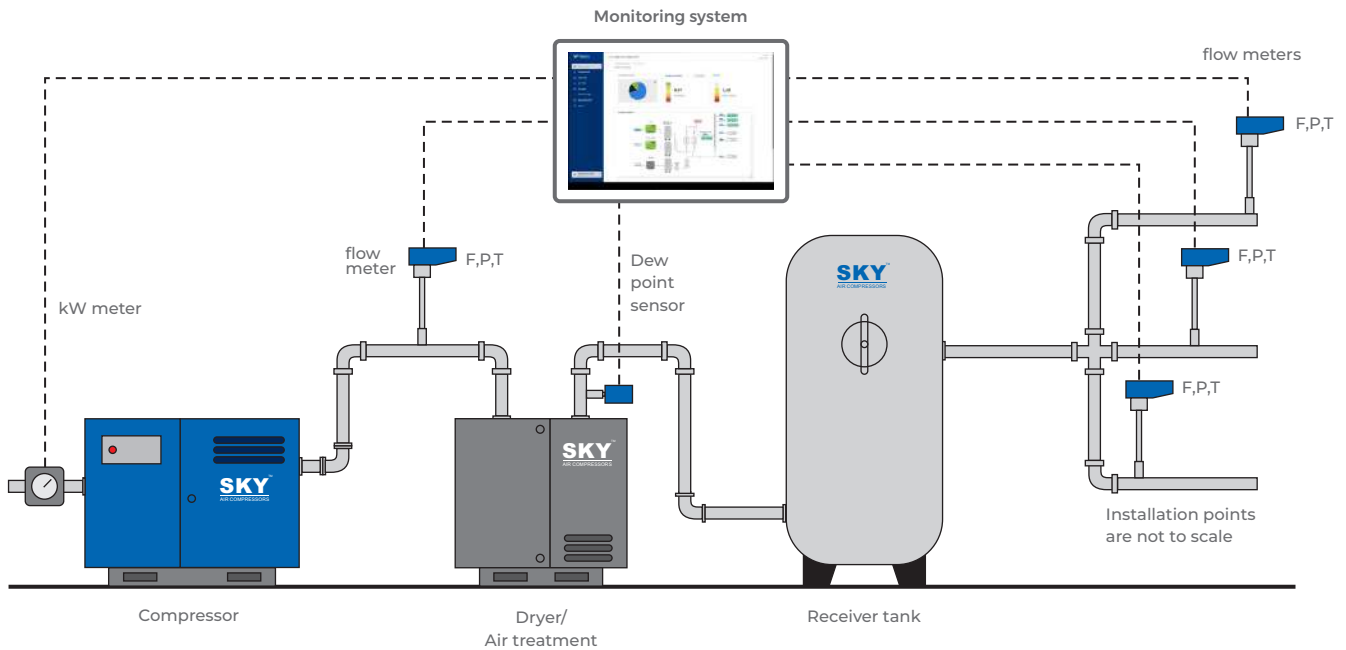

## OUR TOP CUSTOMERS

